

New Model
Sept 18-1970



SM 100

S80 AND S100 ROTAVATORS
for tractors between 65 and 100 h.p.

SPARE PARTS LIST



FROM THE WORLD'S LEADING MANUFACTURER OF ROTARY TILLAGE EQUIPMENT
HOWARD ROTAVATOR CO. LTD.
A MEMBER OF THE ROTARY HOES GROUP OF COMPANIES
Telephone: HORNDON GREEN 361 WEST HORNDON ESSEX Telex 99217 Cables ROTAVATOR, BRENTWOOD
AUSTRALIA · FRANCE · GERMANY · ITALY · NEW ZEALAND · S. AFRICA · SPAIN · U.S.A.



PARTS FOR S GEARBOX ASSY

HOWARD ROTAVATOR CO., INC.
343 S. DIVISION - BOX 100
HARVARD, IL. 60033

1	50474	SPECIAL NUT
1	51151	" "
6	305076	STUD
1	305102	GEARBOX
1	305104	REDUCTION GEAR 23 T.
1	305105	" " 17 T.
1	305112	PICK-OFF GEAR 21 T.
1	305113	" " " 24 T.
1	305114	" " " 22 T.
1	305115	" " " 23 T.
1	305116	PINION SHAFT
1	305118	SPACER
1	305119	END COVER
3	305120	SHIM .005"
3	305121	" .010"
1	305123	GASKET
1	305132	OIL THROWER GEAR 18 T.
1	305134	OIL THROWER ASSEMBLY
1	305135	GASKET
1	305137	SPACER
1	305139	"
1	305140	TOP COVER PLATE
1	305141	GASKET
3	305142	TAB WASHER
1	305208	SPACER
1	305210	"
1	305211	SPECIAL NUT
1	305212	INPUT COVER PLATE
1	305213	SPACER
1	305214	INTERMEDIATE COVER PLATE
3	305215	SHIM .005"
3	305216	" .010

cont.

3	305217	SHIM .005"
3	305218	" .010"
1	305220	INTERMEDIATE SHAFT
1	305221	INPUT SHAFT
1	305222	SPACER
1	305223	SPACER
1	305224	WASHER
1	305228	BREATHER ASSEMBLY
1	305291	PICK-OFF COVER PLATE ASSEMBLY
1	305299	PINION 13 T
1	305300	CROWN WHEEL 35 T
1	305301	GEARBOX SHIM
12	101206080	SETSCREW $\frac{3}{8}$ " NC X 1"
15	101206100	" $\frac{3}{8}$ " NC X $1\frac{1}{4}$ "
2	106204050	SOCKET CAP SCREW $\frac{1}{4}$ " NC X $\frac{5}{8}$ "
6	107208010	NUT $\frac{1}{2}$ " NC
27	108061140	SPRING WASHER $\frac{3}{8}$ "
1	202023540	"O" RING
1	202042080	BONDED SEAL 1" BSP PP45H
1	203031010	DRAIN PLUG $\frac{1}{2}$ " BSP
1	203031070	FLANGED PLUG 1" BSP
2	208001210	CIRCLIP 4" INTERNAL
1	208001600	" 122 mm. INTERNAL
1	208002130	" $1\frac{3}{4}$ " EXTERNAL
1	208009190	MILLS PIN $\frac{1}{4}$ " X $\frac{5}{8}$ "
1	208010300	SPLIT PIN $\frac{5}{32}$ " X $1\frac{3}{4}$ "
2	208010430	" " $\frac{5}{32}$ " X $2\frac{1}{2}$ "
2	251733092	BEARING 25580 CUP - 25520 CONE
3	251740141	" 527 " - 522 "
1	252548152	" HM 212047 - HM 212011
1	263022043	OIL SEAL 300 225 37 DOUBLE LIPPED

S80 AND S100 ROTAVATORS SPARE PARTS LIST

US 305-3048 305305

Illus. No.	Part No.	Description	No. off
1	60954	Machine Serial Number Plate—rivetted to R.H. Sideplate 1	1
UNIVERSAL JOINT ASSEMBLY-HARDY SPICER-PHASED SPLINE			
supersedes Part Nos. 305226 and 305227.			
1	305312	Universal Joint Assembly-Hardy Spicer Ref. 148-TO-0012.	1
1	305313	Universal Joint Assembly-Hardy Spicer Ref. 148-TO-0011.	1
1	B.4008270	Quick Release Yoke Assembly 48-04-813	1
comprising:—			
1	B.4008280	Yoke	1
2	B.4011770	Spring	2
2	B.4011760	Tension Pin	2
2	B.4011780	Pin	2
1	B.4008290	Quick Release Yoke Assembly 48-04-821	1
comprising:—			
1	B.4008300	Yoke	1
1	B.4011770	Spring	1
1	B.4011790	Tension Pin	1
1	B.4011800	Pin	1
2	B.4011740	Spider Assembly	2
8	B.4011750	Circlip	8
2	B.4011030	Lubricator	2
1	B.4008420	Yoke and Splined Bar 4.EX.148-TO-0012	1
1	B.4008400	Yoke and Splined Bar 4.EX.148-TO-0011	1
1	B.4008430	Yoke and Tube	1
1	B.4008410	Yoke and Tube	1
1	B.4010500	Outer Half Guard Assembly	1
1	B.4010510	Inner Half Guard Assembly	1

UNIVERSAL JOINT ASSEMBLY-NEAPCO-BALL SLIP

Illus. No.	Part No.	Description	No. off
1	305226	superseded by: *305312 and *305313	1
1	305227	Universal Joint Assembly—for 540 RPM Tractors	1
comprising:—			
1	B.4008270	Quick Release Yoke Assembly 48-04-813	1
1	B.4008280	Yoke	1
2	B.4011760	Tension Pin	2
2	B.4011770	Spring	2
2	B.4011780	Pin	2
1	B.4008290	Quick Release Yoke Assembly 48-04-821	1
1	B.4008300	Yoke	1
2	B.4011790	Tension Pin	2
2	B.4011770	Spring	2
2	B.4011800	Pin	2
2	B.4011740	Spider Assembly	2
2	B.4011030	Lubricator	2
8	B.4011750	Circlip	8
10	B.4009580	Yoke and Square Shaft	10
11	B.4009590	Yoke and Tube complete	11
11	305229	Universal Joint Guard	11
12—20 not allocated			
CLUTCH ASSEMBLY			
21	S.7108010	Nut 1/2" UNF	6
22	S.8081610	Flat Washer 1/2" dia.	6
23	G.602	Spring	6
24	G.606	Inner Cover	1
25	G.609	Clutch Plate	1
26	G.610	Sleeve	1

G 602 242228
52726
305123
67680

Illus. No.	Part No.	Description	No. off
27	52742	Wearing Disc	2
28	305194	Clutch Disc for Ball Slip Universal Joint superseded by:—	1
29	305304	Clutch Disc for Phased Spline Universal Joint	1
30	52741	Friction Disc	4
30	52745	Pressure Plate	1
30	305305	Clutch Spacer—required when fitted with Phased Spline Universal Joint only	1
30	305316	P.T.O. Pulley	1
GEARBOX ASSEMBLY			
31	51151	Special Nut	1
32	B.8010300	Splitpin 3/8" dia. x 1 1/4" long	1
33	305144	Clutch Guard Assembly—New Type comprising:—	1
305318		Clutch Guard	1
305320		Cover	1
B.8042060		Self Tapping Screw, NPK, Type 'Z'	4
305321		Round Head No. 4 x 1 1/8" long	1
S.1406060		Bracket	1
S.8061140		Setscrew 3/8" UNC. x 1 1/4" long	2
S.7206010		Spring Washer 3/8" dia.	2
S.1406080		Nut 1/2" UNC.	2
S.8061140		Setscrew 3/8" UNC. x 1 1/4" long, Hex. Head	2
37	305214	Spring Washer 3/8" dia.	10
38	305215	Setscrew 3/8" UNC. x 1 1/4" long, Hex. Head	8
39	305212	Intermediate Cover Plate	1
40	305217	Shim .005"—Intermediate Shaft	as required
40	305218	Input Cover Plate	as required
41	B.63022043	Shim .010"—Input Shaft	as required
42	B.2023540	Shim .005"—Input Shaft	as required
43	B.51740141	Oilseal 3" o.d. x 2 1/4" i.d. x .375" w. Double Lipped 13P/300.225.37/B	1
44	305210	'O' Ring 1 1/2" i.d. x 2" o.d. x .210" w.	1
45	305221	Timken Bearing Cup 527—Cone 522	3
46	305105	Spacer	1
47	305222	Input Shaft	1
48	305208	Reduction Gear 17T	1
49	305223	Spacer	1
50	B.8001210	Spacer	1
51	305211	Circlip 4" dia. Internal	2
52	B.8010430	Special Nut	1
53	305132	Splitpin 3/8" dia. x 2 1/4" long	2
54	305134	Oil Thrower Gear 18T.	1
54	305191	Oil Thrower Assembly	1
55	B.50506073	comprising:—	1
56	B.8002020	Spindle Housing Press Assembly	1
57	305192	Spindle Housing	1
58	S.6804050	Bush 1/2" i.d. x 3/4" long	1
59	50474	External Circlip 1/2" dia.	1
60	305224	Washer 1/2" dia.	1
61	305220	Spindle	1
62	B.51733092	Socket Cap Screw 1/2" BSW. x 3/8" long	2
63	305137	Special Nut	1
64	305104	Washer	1
65	305139	Intermediate Shaft	1
66	B.8002130	Timken Bearing Cup 25580—Cone 25520	1
67	305213	Spacer	1
68	305137	Spacer	1
69	305104	Reduction Gear 23T.	1
70	305139	Spacer	1
71	B.8002130	External Circlip 1 1/2" dia.	1
72	305213	Spacer	1

* Not applicable in United States of America.

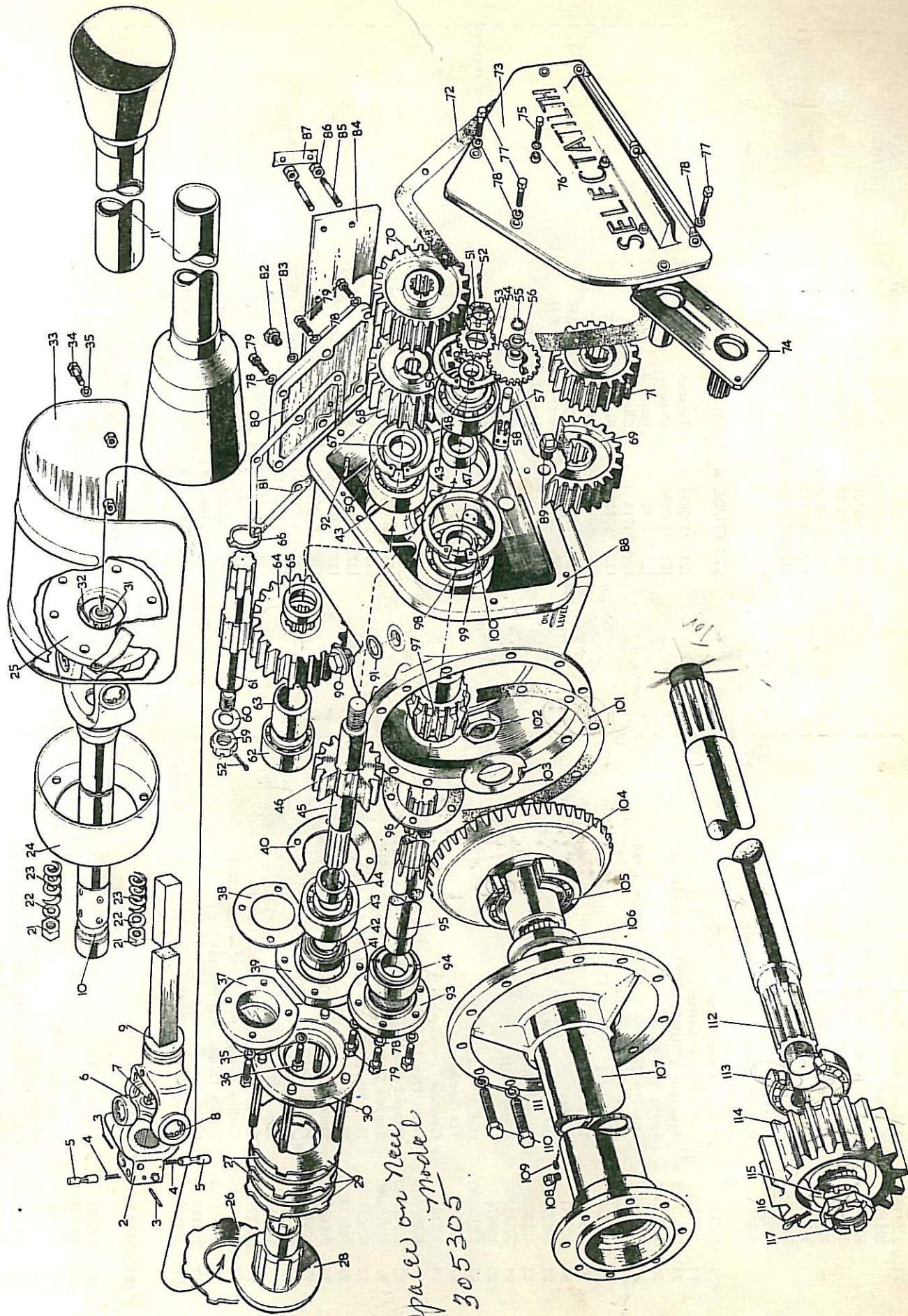

Space on New Model
305305

Illus. No.	Part No.	Description	No. off
68	305112	Pick-off Gear 21T. } Standard	1
69	305113	Pick-off Gear 24T. }	1
70	305115	Pick-off Gear 23T. } Standard	1
71	305114	Pick-off Gear 22T. }	1
	305106	Pick-off Gear 18T. } Alternative	1
	305107	Pick-off Gear 27T. }	1
	305108	Pick-off Gear 19T. } Alternative	1
	305109	Pick-off Gear 26T. }	1
	305110	Pick-off Gear 20T. } Alternative	1
	305111	Pick-off Gear 25T. }	1
72	305123	Gasket	1
	305291	Pick-off Cover Plate Assembly comprising:—	1
73	305122	Pick-off Cover Plate	1
74	305292	Pick-off Gear Carrier	1
74	S.1405080	Setscrew $\frac{1}{8}$ " UNC. x 1" long, Hex. Head	3
76	S.8050940	Spring Washer $\frac{1}{8}$ " dia.	3
77	S.1406100	Setscrew $\frac{3}{8}$ " UNC. x $1\frac{1}{4}$ " long, Hex. Head	7
78	S.8061140	Spring Washer $\frac{3}{8}$ " dia.	19
79	S.1406080	Setscrew $\frac{3}{8}$ " UNC. x 1" long	12
80	305140	Top Cover Plate	1
81	305141	Gasket	1
82	305228	Breather Assembly	1
83	10580	Fibre Washer	1
84	305143	Spacer Plate	1
85	305076	Stud	as required
86	S.7208010	Nut $\frac{1}{2}$ " UNC.	6
87	305142	Tab Washer	6
88	305102	Gearbox	3
89	B.3031010	Drain Plug $\frac{1}{2}$ " BSP. Square Head	1
90	B.3031070	Flanged Plug 1" BSP. Hex. Head	1
91	B.2042080	Bonded Seal 1" BSP. Dowry type PP.45H.	1
92	B.8009190	Mills Pin $\frac{1}{4}$ " dia. x $\frac{3}{8}$ " long. GP.4	1
93	305119	End Cover	1
94	B.51733092	Timken Bearing Cup 25580 — Cone 25520	1
95	305116	Pinion Shaft	1
96	305120	Shim .005"	as required
	305121	Shim .010"	as required
97	305299	Pinion 13T. <i>S/N 7657255 O.R.W.A.R.D.</i>	1
98	B.52548152	Timken Bearing HM.212047 — HM.212011	1
99	B.8001600	Circlip 122mm. dia. Internal	1
100	305118	Spacer	1
101	305135	Gasket	as required

JACKSHAFT ASSEMBLY

102	305183	Special Nut	1
103	305184	Tab Washer	1
104	305300	Crownwheel 35T <i>S/N 7657255 O.R.W.A.R.D.</i>	1
105	B.53054121	Timken Bearing Cone 495A — Cup 493	1
106	B.64030051	Oilseal — Pioneer 11P.400.300.50 Single Lip	1
107	305179	Jackshaft Housing 80" Model	1
	305264	Jackshaft Housing 100" Model	1
108	305228	Breather Assembly	1
109	305264	Fibre Washer	1

STAYTUBE ASSEMBLY

121	*305092	Topmast	1
122	*305098	Drawpin	1
123	*3912	Hook	3
124	*3913	Chain	2
125	*50934	Pin	1
126	*60495	Clip Ring	1
127	*305094	Support Tube L.H.	1
128	*305095	Support Tube R.H.	1
129	*305233	Special Bolt	1
130	*305232	Special Bolt	2
131	*305231	Special Bolt	2
132	*S.8102010	Flat Washer $\frac{3}{8}$ " dia.	as required
133	*S.7110050	Slotted Nut $\frac{3}{8}$ " UNF.	5
134	*B.8010410	Splitpin $\frac{3}{8}$ " dia. x $1\frac{1}{2}$ " long	5
	305296	L.H. Clip Bracket Assembly comprising:—	1
		'U' Bolt	1
135	305285	Clamping Block	1
136	305283	Support Plate	1
137	305284	Spring Washer $\frac{1}{2}$ " dia.	1
138	S.8081440	Nut $\frac{1}{2}$ " UNC.	2
139	S.7208010	Bolt $\frac{3}{8}$ " UNC. x 2" long	2
140	S.1206160	Flat Washer $\frac{3}{8}$ " dia.	1
141	S.8061210	Spring Washer $\frac{3}{8}$ " dia.	1
142	S.8061140	Nut $\frac{3}{8}$ " UNC.	1
143	S.7206010	R.H. Clip Bracket	1
144	305282	Setscrew $\frac{3}{8}$ " UNC. x 1" long, Hex. Head	1
145	S.1406080	Flat Washer $\frac{3}{8}$ " dia.	1
146	S.8061210	Spring Washer $\frac{3}{8}$ " dia.	1
147	S.8061140	Nut $\frac{3}{8}$ " UNC.	1
148	S.7206010	Mounting Pin	1
149	*300299	Mounting Plate	2
150	*305096	Staytube Arm	4
151	305093	Bolt $\frac{3}{8}$ " UNC. x $4\frac{1}{2}$ " long	2
152	*S.1210380	Bolt $\frac{3}{8}$ " UNC. x 2" long	8
153	S.1210160	Bolt $\frac{3}{8}$ " UNC. x $2\frac{1}{2}$ " long	7
154	S.1210200	Spring Washer $\frac{3}{8}$ " dia.	3
155	S.8101740	Nut $\frac{3}{8}$ " UNC.	18
156	S.7210010	Gearbox Support	10 only required when fitted with Converto-Frame 18
157	305101	Front Staytube — 80" Model	1
158	305090	Front Staytube — 100" Model	1

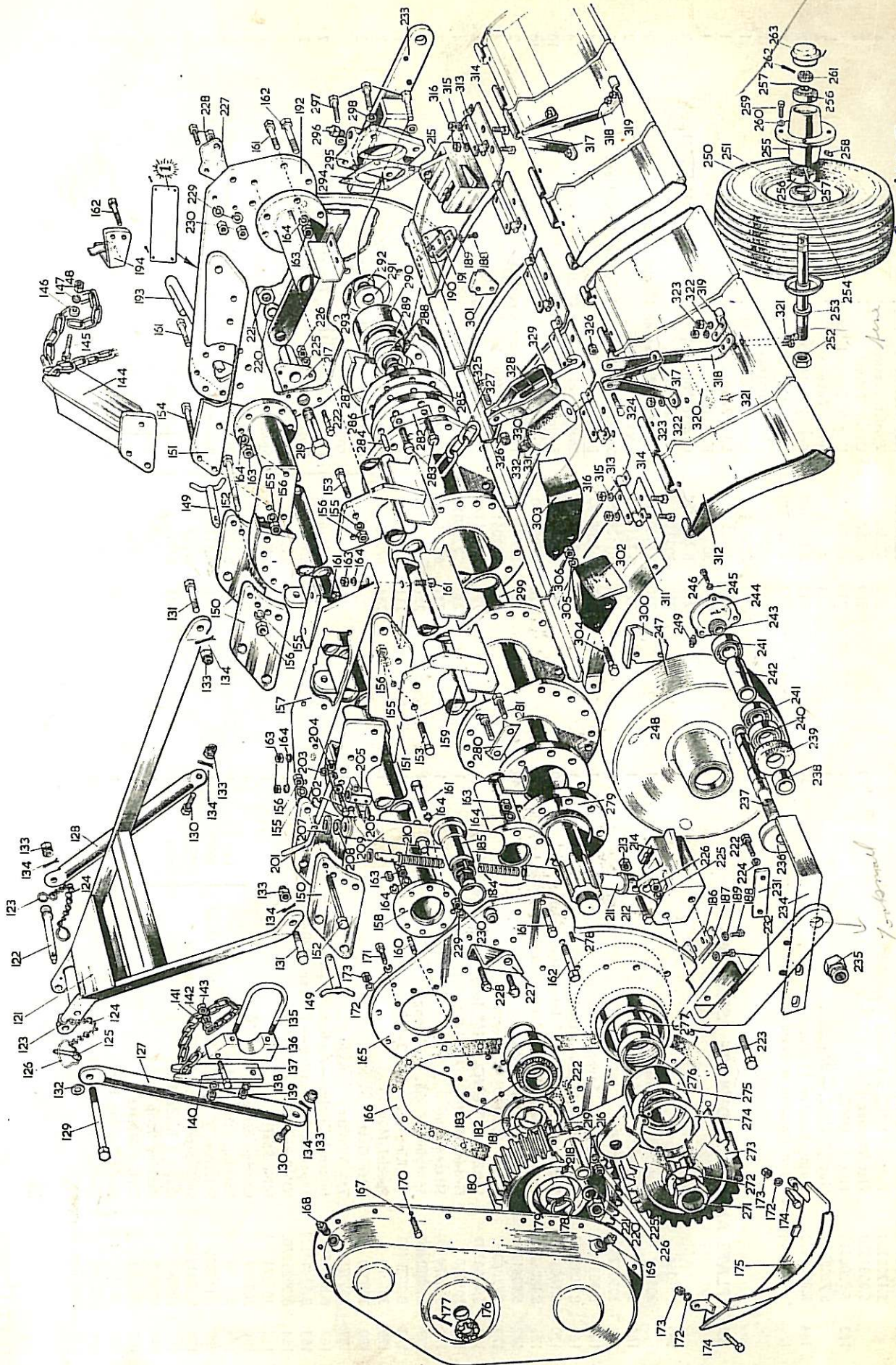

U.S. = PNEUMATIC
 CAN = STEEL

7-6-68

Illus. No.	Part No.	Description	No. off	Illus. No.	Part No.	Description	No. off
159	305091	Rear Staytube — 80" Model	1	203	S.8061140	Spring Washer $\frac{1}{8}$ " dia.	2
	305277	Rear Staytube — 100" Model	1	204	S.7206020	Locknut $\frac{1}{8}$ " UNC.	2
160	305076	Stud	7	205	55481	Handle Block	2
161	S.1408120	Setscrew $\frac{1}{8}$ " UNC. x 1 $\frac{1}{2}$ " long, Hex. Head	18	206	B.8012070	Tension Pin $\frac{1}{8}$ " dia. x 1 $\frac{1}{4}$ " long	4
162	S.1208140	Bolt $\frac{1}{8}$ " UNC. x 1 $\frac{1}{2}$ " long	5	207	S.8122410	Flat Washer $\frac{1}{8}$ " dia.	2
	S.1208320	Bolt $\frac{1}{8}$ " UNC. x 4" long Staytube to Shield	1	208	65650	Thrust Washer	4
	S.8081610	Flat Washer $\frac{1}{8}$ " dia.	1	209	65657	Outer Tube	2
163	S.7208010	Nut $\frac{1}{8}$ " UNC.	29	210	65654	Depth Control Screw	2
	S.7208250	Nut $\frac{1}{8}$ " UNC.—Whizlock	1	211	305053	Inner Tube	2
164	S.8081440	Spring Washer $\frac{1}{8}$ " dia.	30	212	S.1210160	Bolt $\frac{1}{8}$ " UNC. x 2" long, Hex. Head	2
		* Not required when machine is fitted with Convertro-Frarr		213	S.7210020	Locknut $\frac{1}{8}$ " UNC.	2
				214	305057	Clevis Bracket L.H.	1
				215	305072	Clevis Bracket R.H.	1
				216	305054	L.H. Pivot Plate	1
				217	305065	R.H. Pivot Plate	1
				218	B.2030420	Grease Nipple $\frac{1}{4}$ " BSF. Tecalemit NA.5700/1	2
165	305066	Backplate	1	219	305230	Special Bolt	2
	305307	Rotor Bearing Housing	1	220	S.8162630	Shakeproof Washer 1" dia. Internal	2
166	305069	Gasket	1	221	S.7216020	Locknut 1" UNC	2
167	305067	Gearcase	1	222	S.1408120	Setscrew $\frac{1}{8}$ " UNC. x 1 $\frac{1}{2}$ " long, Hex. Head	10
168	B.3031020	Plug $\frac{1}{8}$ " BSP. Square Head	1	223	S.1208180	Bolt $\frac{1}{8}$ " UNC. x 2 $\frac{1}{2}$ " long	4
169	B.3031050	Plug $\frac{1}{8}$ " BSP. Square Head	1	224	S.8081430	Shakeproof Washer $\frac{1}{8}$ " dia. Internal	4
170	S.1406080	Setscrew $\frac{1}{8}$ " UNC. x 1" long, Hex. Head	30	225	S.8081440	Spring Washer $\frac{1}{8}$ " dia.	10
171	S.1406070	Setscrew $\frac{1}{8}$ " UNC. x $\frac{7}{8}$ " long, Hex. Head	8	226	S.7208010	Nut $\frac{1}{8}$ " UNC.	10
172	S.8061140	Spring Washer $\frac{1}{8}$ " dia.	40	227	305089	Trunnion Support Cranked	2
173	S.7206010	Nut $\frac{1}{8}$ " UNC.	21	228	S.1206120	Bolt $\frac{1}{8}$ " UNC. x 1 $\frac{1}{2}$ " long	4
174	S.1406100	Setscrew $\frac{1}{8}$ " UNC. x 1 $\frac{1}{2}$ " long, Hex. Head	2	229	S.8061140	Spring Washer $\frac{1}{8}$ " dia.	4
175	305068	Ground Skid	1	230	S.7206010	Nut $\frac{1}{8}$ " UNC.	4
176	305074	Slotted Nut	1	231	66073	Plate	2
177	B.8010460	Splitpin $\frac{1}{8}$ " dia. x 3" long	1	232	305325	Wheel Arm L.H.	1
178	B.2023410	'O' Ring — Pioneer 3-149	1	233	305323	Wheel Arm R.H.	1
179	305073	Special Nut	1	234	67040	Wheel Scraper	2
180	305070	Idler Gear	1			Depth Control Wheel Assembly	2
181	305075	Tab Washer	1			comprising :—	
182	B.8001590	Internal Circlip — Anderton 1300-113M.	1	235	S.7116130	Philidas Nut 1" UNF. Turret type—WUFP/1	2
183	B.52444121	Taper Roller Bearing — Timken 3920/3980	1	236	67018	Dust Cover	2
184	B.2025070	'O' Ring — Pioneer 3-159	1	237	305241	Axle	2
185	305071	Idler Shaft	1	238	67019	Spacer	2
186	305129	Cutting Blade L.H.	1	239	50084	Felt Seal	2
187	305130	Backing Strip L.H.	1	240	B.62917051	Oilseal $2\frac{1}{2}$ " o.d. x 1 $\frac{1}{4}$ " i.d. x $\frac{1}{2}$ " w. Single Lip 287.175.50	2
188	S.1406080	Setscrew $\frac{1}{8}$ " UNC. x 1" long, Hex. Head	4	241	B.51128081	Ballbearing $1\frac{1}{2}$ " i.d. x 2 $\frac{1}{2}$ " o.d. x $1\frac{1}{8}$ " w. BRM. 1 $\frac{1}{4}$ "	4
189	S.8061130	Shakeproof Washer $\frac{1}{8}$ " dia. Internal	4	242	67017	Distance Tube	2
190	305047	Cutting Blade R.H.	1	243	67015	Split Collar	2
191	305048	Backing Strip R.H.	1	244	67014	Cover	2
192	305052	R.H. Sideplate	1	245	S.8061140	Spring Washer $\frac{1}{8}$ " dia.	6
193	3904	Blade Setting Bar	1	246	S.1406060	Setscrew $\frac{1}{8}$ " UNC. x $\frac{1}{2}$ " long, Hex. Head	6
194	69153	Spring Clip Bracket	1	247	67013	Depth Control Wheel	2
195	— 200 not allocated			248	52441	Welsh Plug	6
				249	B.2030020	Grease Nipple $\frac{1}{8}$ " BSP. Type 12	2

BACKPLATE AND R.H. SIDEPLATE ASSEMBLIES

DEPTH CONTROL ASSEMBLIES

201	3448	Handle	2
202	S.1206180	Bolt $\frac{1}{8}$ " UNC. x 2 $\frac{1}{4}$ " long	2

NOTE.—Parts numbered 235 to 249 inclusive are not fitted on U.S.A. machines.

Illus. No.	Part No.	Description	No. off
DEPTH WHEEL ASSEMBLY — supplied and fitted in U.S.A.			
250		Tyre 4 Ply — 16 x 6.50	2
251		Wheel Rim	2
K.1291		Hub and Axle Assembly complete	2
comprising:—			
252	K.1290	Locknut 1" ANF.	2
253	K.1282	Axle	2
254	K.1286	Oilseal	2
255	K.1283	Hub Assembly complete with Cups	2
256	K.1288	Bearing Cup <i>L44610</i>	4
257	K.1287	Bearing Cone <i>L44613</i>	4
258		Grease Nipple	2
259	K.1289	Spring Washer $\frac{1}{2}$ " ANC. x 1" long. Hex. Head	8
260		Slotted Jam Nut, Special Hex.	8
261	K.1285	Cotter Pin	2
262		Cap	2
263	K.1284	Cap	2
264 — 270 not allocated			
ROTOR DRIVE ASSEMBLY			
271	33690	Special Nut	1
272	305030	Tab Washer	1
273	305027	Rotor Gear	1
274	B.8001570	Internal Circlip 140 mm. dia.	1
275	B.5651448	Roller Bearing 140 mm. o.d. x 65 mm. i.d. x 48 mm. w. SKEFCO-22313C	1
276	B.64030064	Oilseal 4" o.d. x 3" i.d. x $\frac{5}{8}$ " w. Double Lipped — SUPERSEAL-795040-type A.	1
277	305029	Collar	1
278	S.31405030	Socket Screw $\frac{5}{16}$ " UNC. x $\frac{3}{8}$ " long. Hex. Head, Flat Point	2
279	305028	Rotor Drive Shaft	1
B.2023470		'O' Ring 2 $\frac{1}{4}$ " o.d. x 2 $\frac{1}{2}$ " i.d. x .139	1
280	305031	Tab Washer	4
281	S.1410100	Setscrew $\frac{5}{16}$ " UNC. x 1 $\frac{1}{4}$ " long. Hex. Head	8
ROTOR STUB AXLE ASSEMBLY			
282	305031	Tab Washer	4
283	S.1410100	Setscrew $\frac{5}{16}$ " UNC. x 1 $\frac{1}{4}$ " long. Hex. Head	8
284	B.8012260	Tension Pin $\frac{1}{2}$ " dia. x 1 $\frac{1}{4}$ " long	1
285	305298	Rotor Shim—must be supplied as pairs.	as required
286	305040	Stub Axle	1
287	305041	Bearing Housing	1
288	305044	Collar	1
289	B.63526052	Oilseal 3 $\frac{1}{2}$ " o.d. x 2 $\frac{3}{8}$ " i.d. x $\frac{1}{2}$ " w. Double Lipped — Pioneer 13P/350.262.50 B.	1
290	B.52045111	Ballbearing 4 $\frac{1}{2}$ " o.d. x 2" i.d. x 1 $\frac{1}{2}$ " w. BRM.2	1
291	48486	Spacing Washer	1
292	50474	Special Nut	1
293	B.8010420	Splitpin $\frac{1}{8}$ " dia. x 2 $\frac{1}{2}$ " long	1
294	305043	Packing Shim	1
295	305042	End Cover	1

Illus. No.	Part No.	Description	No. off
ROTOR ASSEMBLY			
296	B.2030020	Grease Nipple $\frac{1}{8}$ " BSP. Straight	1
297	S.1308120	Setscrew $\frac{1}{2}$ " UNF. x 1 $\frac{1}{2}$ " long. Hex. Head	4
298	S.8081430	Shakeproof Washer $\frac{1}{2}$ " dia. Internal	4
299	305055	Rotor — 80" Model	1
300	300228	Shearing Blade L.H. } for 100" Model only	1
301	305280	Shearing Blade R.H. }	1
302	9919	Universal Blade L.H. } Standard fitment	80" 24
303	9920	Universal Blade R.H. }	24 30
9910		Long Shank Blade L.H. } Alternative fitment	24 30
9911		Long Shank Blade R.H. }	24 30
9950		Speed Blade L.H. Heavy Duty } Alternative fitment	24 30
9951		Speed Blade R.H. Heavy Duty }	24 30
9850		Blade Bolt	96 124
304	9850	Blade Bolt	96 124
305	S.8101720	Spring Washer $\frac{5}{8}$ " dia. Internal	96 124
306	67557	Special High Nut	96 112
307	S.7110010	Nut $\frac{3}{8}$ " UNF.	12
307 — 310 not allocated			
SHIELD ASSEMBLY			
311	305012	Main Shield — 80" Model	1
305257		Main Shield — 100" Model	1
312	305024	Trailing Board — 80" Model	2
305265		Trailing Board — 100" Model	2
313	50724	Hinge	6
314	S.1308100	Setscrew $\frac{1}{2}$ " UNF. x 1 $\frac{1}{4}$ " long. Hex. Head	24
315	S.8081430	Shakeproof Washer $\frac{1}{2}$ " dia. Internal	24
316	S.7108010	Nut $\frac{1}{2}$ " UNF.	24
317	65644	Front Support	4
318	65645	Centre Stay	2
319	65646	Hook	2
320	65647	Stiffening Strip	2
321	S.1406100	Setscrew $\frac{3}{8}$ " UNC. x 1 $\frac{1}{4}$ " long. Hex. Head	8
322	S.8061130	Shakeproof Washer $\frac{3}{8}$ " dia. Internal	8
323	S.7206010	Nut $\frac{3}{8}$ " UNC.	8
324	S.1206160	Bolt $\frac{3}{8}$ " UNC. x 2" long	2
325	S.1206110	Bolt $\frac{3}{8}$ " UNC. x 1 $\frac{1}{2}$ " long	2
326	S.7206030	Phillidas Nut $\frac{3}{8}$ " UNC. Ref. JUCI/1	4
327	65648	Adjuster Chain	2
305026		Damper Assembly	2
comprising:—			
328	305034	Rod	2
329	305025	Shackle	2
330	305035	Rubber Damper	2
331	305036	Washer	2
332	S.7206130	Phillidas Nut $\frac{3}{8}$ " UNC. Ref. JUCP/1	2

Following Howard policy of continuous improvement, the Company reserves the right to amend model specifications and prices at any time without notice.

S80 AND S100 ROTAVATORS — NUMERICAL PARTS LIST

N.I. = Not Illustrated.

Part No.	Illus. No.	Part No.	Illus. No.	Part No.	Illus. No.	Part No.	Illus. No.	Part No.	Illus. No.	Part No.	Illus. No.	Part No.	Illus. No.	Part No.	Illus. No.	Part No.	Illus. No.	Part No.	Illus. No.
G.602	23	305024	312	305108	70	305226	2	S.1206120	228	S.7208250	163	B.4008410	N.I.	B.4011770	203	B.4011770	N.I.	B.4011770	N.I.
3448	201	305025	329	305109	71	305227	2	S.1206160	140	S.7210010	156	B.4008420	N.I.	B.4011780	229	B.4011780	N.I.	B.4011780	N.I.
3904	193	305026	328	305110	70	305228	82	S.1206160	324	S.7210020	213	B.4008430	N.I.	B.4011790	3	B.4011790	N.I.	B.4011790	N.I.
3912	123	305027	273	305111	70	305228	108	S.1206180	202	S.7216020	221	B.4009580	9	B.4011800	5	B.4011800	N.I.	B.4011800	N.I.
3913	124	305028	279	305112	68	305229	11	S.1206180	298	S.7216020	221	B.4009590	10	B.8001210	50	B.8001210	N.I.	B.8001210	N.I.
9850	304	305029	277	305113	69	305230	219	S.1206180	298	S.8042060	N.I.	B.4010500	N.I.	B.8001570	274	B.8001570	N.I.	B.8001570	N.I.
9910	302	305030	272	305114	71	305231	131	S.1208140	162	S.8050940	76	B.4010510	N.I.	B.8001600	99	B.8001600	N.I.	B.8001600	N.I.
9911	303	305031	280	305115	70	305232	130	S.1208180	223	S.8061130	189	B.4010510	N.I.	B.8002020	55	B.8002020	N.I.	B.8002020	N.I.
9919	302	305031	282	305116	95	305233	129	S.1210160	153	S.8061140	33	B.4010510	N.I.	B.8002130	66	B.8002130	N.I.	B.8002130	N.I.
9920	303	305034	328	305118	100	305241	237	S.1210160	212	S.8061140	35	B.4011030	7	B.8009190	92	B.8009190	N.I.	B.8009190	N.I.
9950	302	305035	330	305119	93	305242	240	S.1210200	154	S.8061140	78	B.4011030	N.I.	B.8010410	134	B.8010410	N.I.	B.8010410	N.I.
9951	303	305036	331	305120	96	305257	311	S.1210380	152	S.8061140	142	B.4011740	N.I.	B.8010420	293	B.8010420	N.I.	B.8010420	N.I.
10580	83	305040	286	305121	96	305263	112	S.1308100	314	S.8061140	147	B.4011740	N.I.	B.8010430	52	B.8010430	N.I.	B.8010430	N.I.
10580	109	305041	287	305122	72	305264	107	S.1308100	314	S.8061140	147	B.4011740	N.I.	B.8010460	177	B.8010460	N.I.	B.8010460	N.I.
33690	271	305042	295	305129	187	305265	312	S.1405080	75	S.8061140	172	B.4011770	4	B.8001570	274	B.8001570	N.I.	B.8001570	N.I.
48486	291	305043	294	305130	186	305265	312	S.1405080	75	S.8061140	172	B.4011770	4	B.8001590	182	B.8001590	N.I.	B.8001590	N.I.
50084	239	305044	288	305132	53	305276	158	S.1406060	246	S.8061140	242	B.4011780	3	B.8001600	99	B.8001600	N.I.	B.8001600	N.I.
50474	59	305047	190	305134	54	305277	159	S.1406070	171	S.8061140	141	B.4011780	3	B.8001610	66	B.8001610	N.I.	B.8001610	N.I.
50474	292	305048	191	305135	101	305280	301	S.1406080	34	S.8061210	146	B.4011780	N.I.	B.8002020	55	B.8002020	N.I.	B.8002020	N.I.
50724	313	305052	192	305137	63	305282	144	S.1406080	79	S.8061210	146	B.4011780	N.I.	B.8002130	66	B.8002130	N.I.	B.8002130	N.I.
50934	125	305053	211	305139	65	305283	136	S.1406080	145	S.8061210	141	B.4011790	3	B.8009190	92	B.8009190	N.I.	B.8009190	N.I.
51151	31	305054	216	305140	80	305284	137	S.1406080	170	S.8061210	146	B.4011790	3	B.8010300	32	B.8010300	N.I.	B.8010300	N.I.
52441	24	305055	299	305141	81	305285	135	S.1406080	188	S.8061210	146	B.4011790	3	B.8010410	134	B.8010410	N.I.	B.8010410	N.I.
52726	24	305057	214	305142	87	305291	73	S.1406100	36	S.8061440	111	B.4011790	3	B.8010420	293	B.8010420	N.I.	B.8010420	N.I.
52741	29	305065	217	305143	84	305292	74	S.1406100	77	S.8061440	164	B.4011790	3	B.8010430	52	B.8010430	N.I.	B.8010430	N.I.
52742	27	305066	165	305144	33	305296	135	S.1406100	174	S.8061440	225	B.4011790	3	B.8010460	177	B.8010460	N.I.	B.8010460	N.I.
52745	30	305067	167	305178	112	305297	54	S.1406100	321	S.8061610	22	B.4011790	3	B.8010490	116	B.8010490	N.I.	B.8010490	N.I.
55481	205	305068	175	305179	107	305298	285	S.1406100	110	S.8061610	22	B.4011790	3	B.8012070	206	B.8012070	N.I.	B.8012070	N.I.
60495	126	305069	166	305181	114	305299	97	S.1408120	161	S.8061610	56	B.4011790	3	B.8012260	284	B.8012260	N.I.	B.8012260	N.I.
60954	1	305070	180	305182	117	305300	104	S.1408120	222	S.8061610	56	B.4011790	3	B.8020600	33	B.8020600	N.I.	B.8020600	N.I.
65644	317	305071	185	305183	102	305304	28	S.1410100	281	S.8101730	305	B.4011790	3	B.8023470	178	B.8023470	N.I.	B.8023470	N.I.
65645	318	305072	215	305184	103	305305	N.I.	S.1410100	283	S.8101740	155	B.4011790	3	B.2023540	279	B.2023540	N.I.	B.2023540	N.I.
65646	319	305073	179	305185	115	305307	165	S.1410100	283	S.8122410	207	B.4011790	3	B.2025070	184	B.2025070	N.I.	B.2025070	N.I.
65647	320	305074	176	305191	54	305312	N.I.	S.6804050	58	S.8122410	207	B.4011790	3	B.2030020	249	B.2030020	N.I.	B.2030020	N.I.
65648	327	305075	181	305192	57	305312	N.I.	S.6804050	58	S.8122410	207	B.4011790	3	B.2030420	218	B.2030420	N.I.	B.2030420	N.I.
65650	208	305076	85	305193	25	305313	N.I.	S.7108010	316	S.8122410	207	B.4011790	3	B.2042010	80	B.2042010	N.I.	B.2042010	N.I.
65654	210	305076	160	305194	28	305316	N.I.	S.7108010	316	B.2023410	178	B.4011790	3	B.2042080	91	B.2042080	N.I.	B.2042080	N.I.
65657	209	305089	227	305208	48	305318	33	S.7110050	306	B.2023470	279	B.4011790	3	B.3031010	89	B.3031010	N.I.	B.3031010	N.I.
66073	231	305090	158	305210	44	305320	33	S.7116130	235	B.2023540	42	B.4011790	3	B.3031020	168	B.3031020	N.I.	B.3031020	N.I.
67013	247	305091	159	305211	51	305323	233	S.7206010	143	B.2025070	184	B.4011790	3	B.3031050	169	B.3031050	N.I.	B.3031050	N.I.
67014	244	305092	121	305212	39	305325	232	S.7206010	148	B.2030020	249	B.4011790	3	B.3031070	90	B.3031070	N.I.	B.3031070	N.I.
67015	243	305093	151	305213	67	K.1282	253	S.7206010	173	B.2030420	218	B.4011790	3	B.4008270	2	B.4008270	N.I.	B.4008270	N.I.
67017	242	305094	127	305214	37	K.1283	255	S.7206010	230	B.2042010	80	B.4011790	3	B.4008280	2	B.4008280	N.I.	B.4008280	N.I.
67018	236	305095	128	305215	38	K.1284	263	S.7206010	323	B.3031010	89	B.4011790	3	B.52444121	183	B.52444121	N.I.	B.52444121	N.I.
67019	238	305096	150	305216	38	K.1285	261	S.7206020	204	B.3031020	168	B.4011790	3	B.52548152	98	B.52548152	N.I.	B.52548152	N.I.
67040	234	305098	122	305217	40	K.1286	254	S.7206030	326	B.3031050	169	B.4011790	3	B.53054121	105	B.53054121	N.I.	B.53054121	N.I.
67557	306	305101	157	305218	40	K.1287	257	S.7206030	326	B.3031070	90	B.4011790	3	B.56514481	275	B.56514481	N.I.	B.56514481	N.I.
69153	194	305102	88	305220	61	K.1288	256	S.7206130	332	B.4008270	2	B.4011790	3	B.62917051	240	B.62917051	N.I.	B.62917051	N.I.
69680	26	305104	64	305221	45	K.1289	259	S.7208010	86	B.4008270	2	B.4011790	3	B.63022043	41	B.63022043	N.I.	B.63022043	N.I.
700228	300	305105	46	305222	47	K.1290	252	S.7208010	139	B.4008280	2	B.4011790	3	B.63526052	289	B.63526052	N.I.	B.63526052	N.I.
7299	149	305106	70	305223	49	K.1291	252	S.7208010	163	B.4008290	2	B.4011790	3	B.64030051	289	B.64030051	N.I.	B.64030051	N.I.
75012	311	305107	71	305224	60	S.1206120	325	S.7208010	226	B.4008300	2	B.4011790	3	B.64030064	289	B.64030064	N.I.	B.64030064	N.I.